

# Swarland Purple Sandfaced 73mm

## Product Technical Information Sheet

Wienerberger Code	24177280
Production Plant	Denton
Manufacture	Extruded/Wirecut
Configuration	Perforated
Colour	Purple
Appearance	Sanded
Work Size (mm)	215 x 102.5 x 73
Pack Quantity	340 No.
Typical Pack Weight	810 kg

## Technical Properties to BS EN 771-1

Size Tolerance (Mean/Range)	T2/R1
Gross Dry Density (kg/m <sup>3</sup> /Tolerance)	1480 (D1)
Compressive Strength (N/mm <sup>2</sup> )	≥40
Thermal Conductivity (W/(m·K))	P=90% 0.69
Durability Designation	F2
Water Absorption (%)	≤12
Initial Rate of Water Absorption (kg/(m <sup>2</sup> ·min))	Min. 1.0 Max. 2.2
Active Soluble Salts	S2
Reaction to Fire	Class A1

**Issue Date: 28/07/2020**

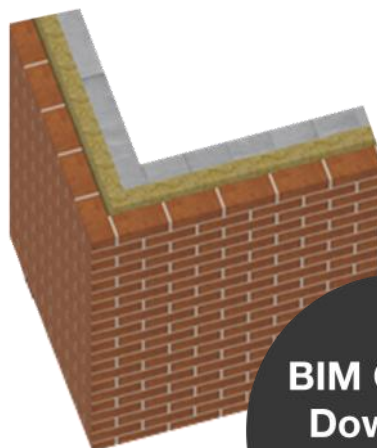
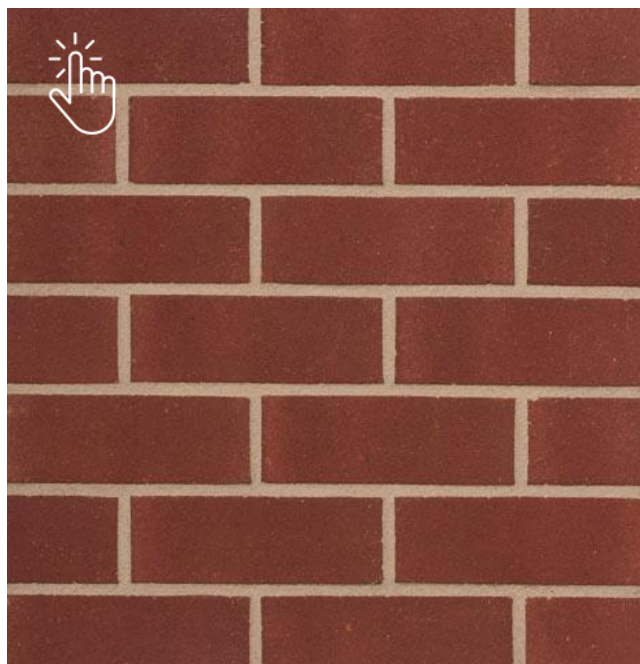

**BIM Objects  
Download**



1000+ products to choose from



Expert help and advice



Comprehensive Design Services



Technical Support